

COLD BREW & NITRO COUNTERTOP SYSTEM

Daily & Weekly Cleaning Guide



Use this guide for your daily and weekly cleaning instructions for the
Cold Brew & Nitro Countertop System.

The front page displays a quick overview to use as a checklist. The additional pages show detailed steps for the cleaning processes.

DAILY CLEANING CHECKLIST

(for details, proceed to page 2)

- Rinse The Beverage Lines**
 - Purge unit of remaining coffee; reserve if possible
 - Fill cleaning canister halfway with clean water
 - Connect intake hose to canister
 - Turn **ON** machine pressure
 - Switch unit to “COLD BREW” dispense setting
 - Dispense all water into cleaning pitcher
 - Close faucet
 - Rinse cleaning canister and store.

- Clean Exterior of Machine**
 - Remove drip tray and cover
 - Wash in a mild non-abrasive detergent solution.
 - Rise and dry.
 - Wipe down the exterior of the machine with a soft clean damp cloth
 - Replace drip tray and cover

WEEKLY CLEANING CHECKLIST

(for details, proceed to page 4)

- Rinse The Beverage Lines**
 - Follow the “*Rinse the Beverage Lines*” instructions above.
- Rinse Intake Filter**
 - Open filter adapter with provided wrench
 - Take out filter insert and rinse with warm water
 - Replace filter into filter adapter; close & tighten
- Rinse Dispense Nozzle**
 - Unscrew upper part of dispense nozzle
 - Rinse inside of nozzle with clean water
 - Reattach nozzle to faucet
- Sanitize Cold Brew Servers**
 - Unscrew upper part of dispense nozzle
 - Rinse inside of nozzle with clean water
 - Reattach nozzle to faucet

- Sanitize The Beverage Lines**
 - Add 2 tsp. One-Pro cleaning powder to cleaning container
 - Fill cleaning container halfway with warm water; secure lid
 - Shake cleaning container for 10sec.
 - Connect beverage line to cleaning canister
 - Dispense cleaning solution into empty pitcher; **close faucet**
 - Wait 10min
 - **Thoroughly** rinse cleaning container with clean water
 - Refill cleaning container halfway with clean warm water
 - Connect beverage line to cleaning canister
 - Open faucet and dispense all rinse water into a cleaning pitcher
 - Close faucet

COLD BREW & NITRO COUNTERTOP SYSTEM

Daily Cleaning



Nestlé
Professional
Solutions

RINSING THE BEVERAGE LINES

Materials Needed:

- Provided cleaning canister
- Small empty pitcher/container (3 liters minimum)



1
Disconnect the intake hose from the server by pressing the metal button on the server adapter



2
Turn ON the system pressure using the switch on the back of the unit



3
Turn the beverage selection knob on the front of the unit to COLD BREW

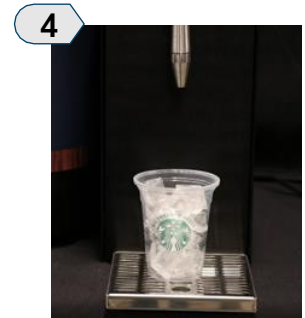

4
Purge the system of any remaining coffee by dispensing into a 16oz cup until flow stops



5
Coffee purged from the unit can be reserved and used later ***if it meets shelf-life requirements***

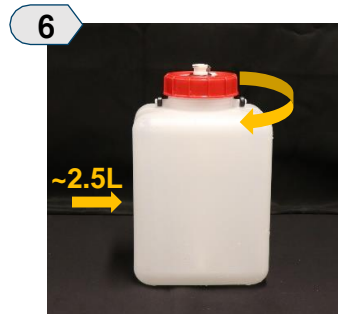

6
Fill cleaning canister halfway (approx. 2.5L) with clean, lukewarm water; attach lid and tighten

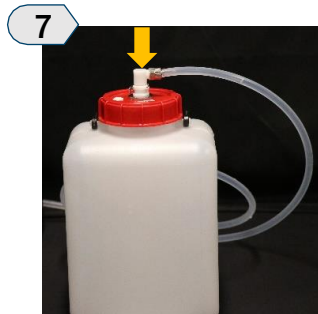

7
Attach the dispense end of the intake hose to the cleaning container. Push until the connectors “click” in place



8
Turn ON the system pressure using the switch on the back of the unit



9
Turn the beverage selection knob on the front of the unit to COLD BREW

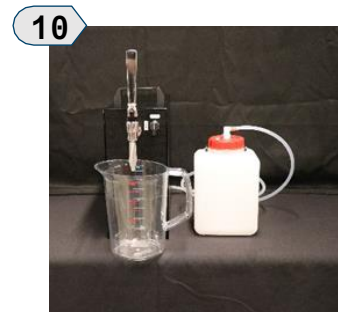

10
Place an empty container (min. 3L) under the faucet



11
Open faucet and dispense all water in the container. Close faucet.



12
Disconnect the intake hose from the cleaning canister. Rinse the canister and store.

COLD BREW & NITRO COUNTERTOP SYSTEM

Daily Cleaning

RINSING THE BEVERAGE LINES

Materials Needed:

- Provided cleaning canister
- Small empty pitcher/container (3 liters minimum)

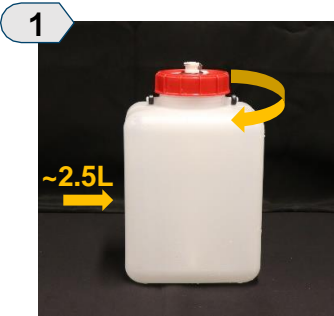

Fill cleaning canister halfway (approx. 2.5L) with clean, lukewarm water; attach lid and tighten



Attach the dispense end of the intake hose to the cleaning container. Push until the connectors "click" in place



Turn ON the system pressure using the switch on the back of the unit



Turn the beverage selection knob on the front of the unit to COLD BREW

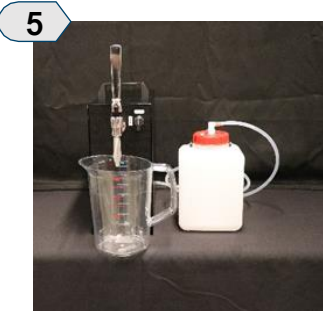

Place an empty container (min. 3L) under the faucet



Open faucet and dispense all water in the container. Close faucet.



Disconnect the intake hose from the cleaning canister. Rinse the canister and store.

COLD BREW & NITRO COUNTERTOP SYSTEM

Daily Cleaning



Nestlé
Professional
Solutions

CLEANING THE EXTERIOR OF THE MACHINE

- Materials Needed:**
- Mild non-abrasive detergent
 - Clean soft cloth

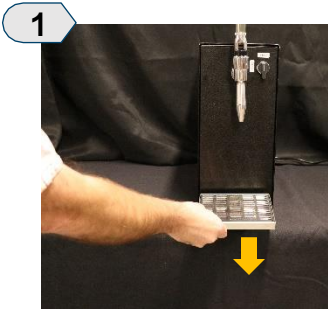

1 Remove the drip tray and cover from in front of the machine.



2 Wash in a mild non-abrasive detergent solution.
Rinse and dry

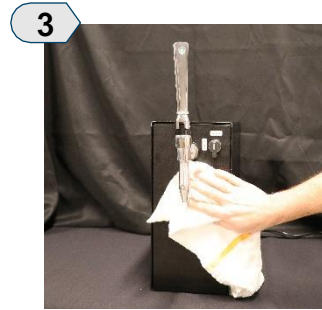

3 Wipe down the exterior of the machine with a soft clean damp cloth

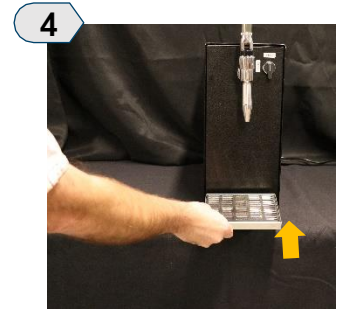

4 Replace drip tray and cover

COLD BREW & NITRO COUNTERTOP SYSTEM

Weekly Cleaning

RINSING THE BEVERAGE LINES

Refer to the [Rinsing the Beverage Lines](#) instructions located in the **Daily Cleaning** section.

RINSING THE INTAKE FILTER

Materials Needed:

- Inline filter wrench

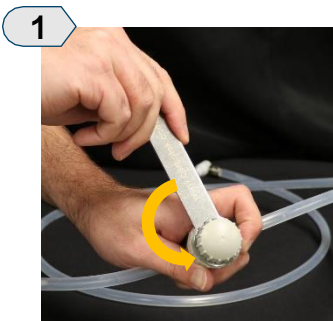

1 Open the inline filter adapter with the inline filter wrench by turning COUNTERCLOCKWISE.

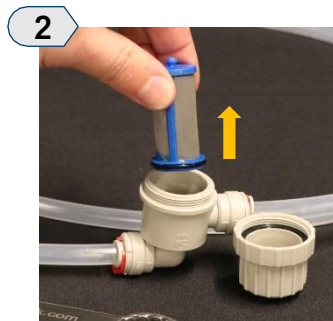

2 Remove filter insert.



3 Rinse filter insert under cool, clean water.

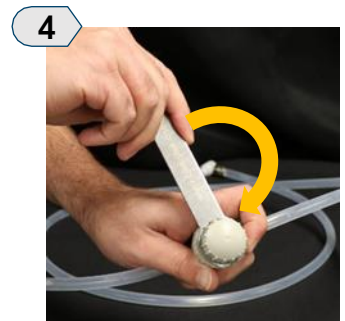

4 Replace filter into the filter adapter
Close the adapter and tighten CLOCKWISE with the inline filter wrench

RINSING THE DISPENSE NOZZLE

Materials Needed:

- Small wrench (optional)

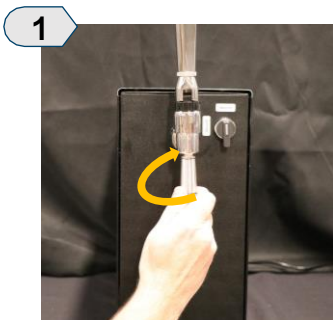

1 Using your hand or small wrench, unscrew the upper part of dispense nozzle COUNTERCLOCKWISE.



2 Rinse inside of nozzle under clean water

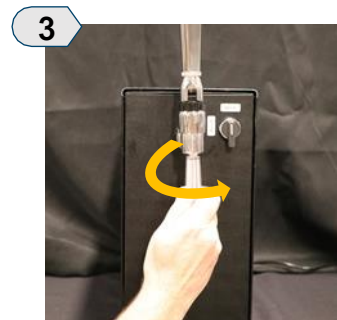

3 Reattach nozzle to faucet by tightening with hand or wrench COUNTERCLOCKWISE.

COLD BREW & NITRO COUNTERTOP SYSTEM

Weekly Cleaning



Nestlé
Professional
Solutions

SANITIZING THE BEVERAGE LINES

Materials Needed:

- 2 tsp. One-Pro cleaning powder
- Cleaning container
- Small empty container (3 liters minimum)



1 Add 2 tsp. of One-Pro cleaning powder to empty cleaning canister.

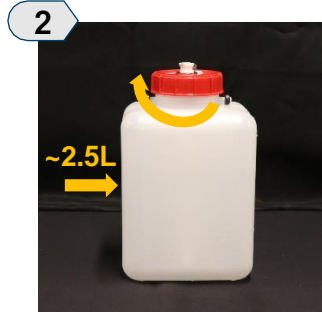

2 Fill cleaning canister halfway (approx. 2.5L) with clean, lukewarm water; attach lid and tighten



3 Shake canister for approx. 10 sec. to mix solution



4 Attach the dispense end of the intake hose to the cleaning container. Push until the connectors "click" in place



5 Turn ON the system pressure using the switch on the back of the unit



6 Turn the beverage selection knob on the front of the unit to COLD BREW

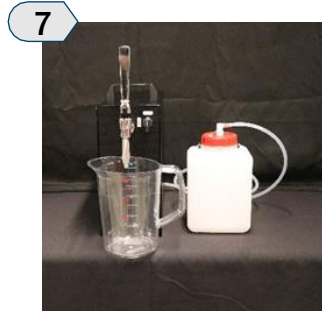

7 Place an empty container (min. 3L) under the faucet

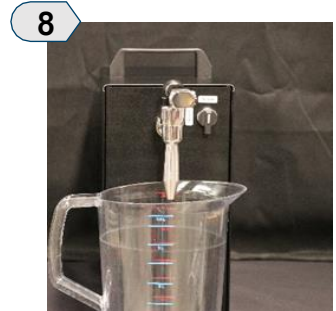

8 Open faucet and dispense all of the cleaning solution. Close faucet.

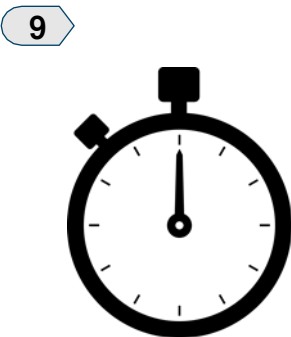

9 Allow unit to sit for 10 min.



10 Disconnect the intake hose from the cleaning canister

Empty and **thoroughly rinse** the cleaning container.

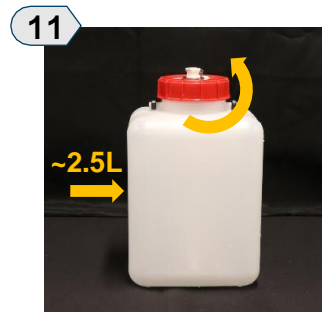

11 Fill the **thoroughly** rinsed container halfway with **clean warm water**.



12 Attach the dispense end of the intake hose to the cleaning container. Push until the connectors "click" in place

COLD BREW & NITRO COUNTERTOP SYSTEM

Weekly Cleaning



Nestlé
Professional
Solutions

SANITIZING THE BEVERAGE LINES – cont'd

Materials Needed:

- 2 tsp. One-Pro cleaning powder
- Cleaning container
- Small empty container (3 liters minimum)

13

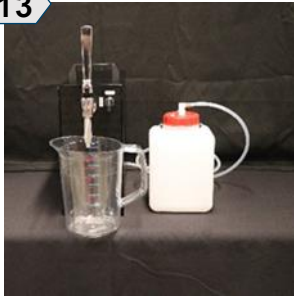

Place an empty container (min. 3L) under the faucet

14



Keep the beverage selection knob on COLD BREW.

15



Open faucet and dispense all rinse water into a cleaning pitcher.

16



Close faucet.
Disconnect the cleaning canister.
Empty pitcher.